

Tryckknappsgränssnitt 92732

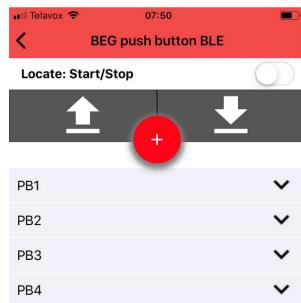

PB1
PB2
PB3
PB4

Target Address
Group 0...15, Broadcast (BC)

Control type
Ejective push button (återfjädrande tryckknapp)
Switch

Short Press
Toggle (Max/ Off)
Off
Recall Max Level
Lng_Param_Goto_Scene
Toggle (Scene/ Off)
Value (%)
B.E.G Lock
B.E.G Unlock
B.E.G Central Off
Deactivated
Toggle (Value (%) / Off)

Long Press
Toggle (Up/ Down)
Step Up
Step Down
Lng_Param_Goto_Scene
Toggle (Scene/ Off)
Value (%)
B.E.G Lock
B.E.G Unlock
B.E.G Central Off
Deactivated
Toggle (Value (%) / Off)

Long Press Duration
500ms
600ms
800ms
1S
1,2S
1,5S
2S
3S

Power-on Behavior
No Action
Maximum-Level
Off

Positive transition
Toggle (Max/ Off)
Off
Recall Max Level
Lng_Param_Goto_Scene
Toggle (Scene/ Off)
Value (%)
B.E.G Lock
B.E.G Unlock
B.E.G Central Off
Deactivated
Toggle (Value (%) / Off)

Negative transition
Toggle (Max/ Off)
Off
Recall Max Level
Lng_Param_Goto_Scene
Toggle (Scene/ Off)
Value (%)
B.E.G Lock
B.E.G Unlock
B.E.G Central Off
Deactivated
Toggle (Value (%) / Off)

Follow-up time Active Inactive Active
Scene Scene 0... 16
Scene Scene 0... 16
Value (%) Value 0... 100%

Value (%) Value 0... 100%

Scene Scene 0... 16
Scene Scene 0... 16
Value (%) Value 0... 100%

Value (%) Value 0... 100%

Follow-up time 1s... 2h 59s

Detektor PD11 93068

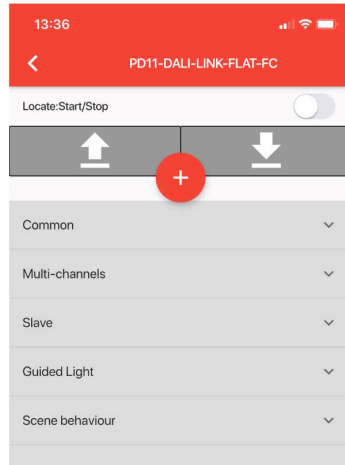

Common
Multi-channels
Slave
Guided Light
Scene behaviour

Common	<ul style="list-style-type: none"> Target group Motion Sensitivity Master Operation Mode Follow-up Time Output Type Reflection Factor Set Value Brightness Regulating Speed Switch-on-Level Orientation Light Orientation Light Level Orientation Light Time Power-on-Behavior Level Transmit When Locking Level Transmit When Unlocking Burn-in-Time Regulate Lag Time Led indication Switch off hysteresis Delay on time Delay off time 	<ul style="list-style-type: none"> Group 0...15, broadcast High, Medium, Low Fully-Automatic, Semi-Automatic, CDS, Master off 1s... 2h59min Regulating, Switching Very bright (1), Bright (0,5), Medium (0,33), Dark (0,25), Very dark (0,2) 5...2500lux Fast, Medium, Slow Calculated, 5%, 10%, 20%, 30%, 40%, 50%, 60%, 70%, 80%, 90%, 100% Off, Permanent, Timed 5...100% 1s... 2h59min No action, On, Off Off, 5%, 10%, 20%, 30%, 40%, 50%, 60%, 70%, 80%, 90%, 100%, Deactivated Off, 5%, 10%, 20%, 30%, 40%, 50%, 60%, 70%, 80%, 90%, 100%, Deactivated 1...100hour 0...20s On, Off 5...1000Lux 1s... 2h59min 1s... 2h59min
Multi-channels	<ul style="list-style-type: none"> Enable CH2 Offset CH2 Enable CH3 Offset CH3 Enable Board light Board light mode Joint control group for CH1+2+3 	<ul style="list-style-type: none"> Deactive, Active 0%, -5%, -10%, -15%, -20%, -25%, -30% Deactive, Active 0%, -5%, -10%, -15%, -20%, -25%, -30% Deactive, Active Fully-Automatic, Semi-Automatic Deactive, Active
Slave	<ul style="list-style-type: none"> Repeat time motion 	<ul style="list-style-type: none"> 1s... 2h59min
Guided Light	<ul style="list-style-type: none"> Motion in G0...G15, BC 	<ul style="list-style-type: none"> Main Light, Orien. Light, Ignore
Scene behaviour	<ul style="list-style-type: none"> Scene 0...15 	<ul style="list-style-type: none"> B.E.G LOCK, B.E.G UNLOCK, Auto-off, Ignore

Detektor PD4N 93377

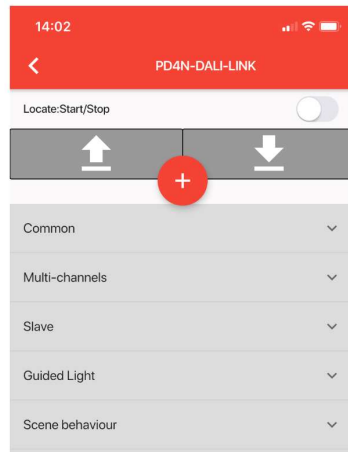

Common
Multi-channels
Slave
Guided Light
Scene behaviour

Common	<ul style="list-style-type: none"> Target group Motion Sensitivity Master Operation Mode Follow-up Time Output Type Reflection Factor Set Value Brightness Regulating Speed Switch-on-Level Orientation Light Orientation Light Level Orientation Light Time Power-on-Behavior Level Transmit When Locking Level Transmit When Unlocking Burn-in-Time Regulate Lag Time Led indication Switch off hysteresis Delay on time Delay off time 	<ul style="list-style-type: none"> Group 0...15, broadcast High, Medium, Low Fully-Automatic, Semi-Automatic, CDS, Master off 1s... 2h59min Regulating, Switching Very bright (1), Bright (0,5), Medium (0,33), Dark (0,25), Very dark (0,2) 5...2500lux Fast, Medium, Slow Calculated, 5%, 10%, 20%, 30%, 40%, 50%, 60%, 70%, 80%, 90%, 100% Off, Permanent, Timed 5...100% 1s... 2h59min No action, On, Off Off, 5%, 10%, 20%, 30%, 40%, 50%, 60%, 70%, 80%, 90%, 100%, Deactivated Off, 5%, 10%, 20%, 30%, 40%, 50%, 60%, 70%, 80%, 90%, 100%, Deactivated 1...100hour 0...20s On, Off 5...1000Lux 1s... 2h59min 1s... 2h59min
Multi-channels	<ul style="list-style-type: none"> Enable CH2 Offset CH2 Enable CH3 Offset CH3 Enable Board light Board light mode Joint control group for CH1+2+3 	<ul style="list-style-type: none"> Deactive, Active 0%, -5%, -10%, -15%, -20%, -25%, -30% Deactive, Active 0%, -5%, -10%, -15%, -20%, -25%, -30% Deactive, Active Fully-Automatic, Semi-Automatic Deactive, Active
Slave	<ul style="list-style-type: none"> Repeat time motion 	<ul style="list-style-type: none"> 1s... 2h59min
Guided Light	<ul style="list-style-type: none"> Motion in G0...G15, BC 	<ul style="list-style-type: none"> Main Light, Orien. Light, Ignore
Scene behaviour	<ul style="list-style-type: none"> Scene 0...15 	<ul style="list-style-type: none"> B.E.G LOCK, B.E.G UNLOCK, Auto-off, Ignore

Detektor PD4-GH 93845

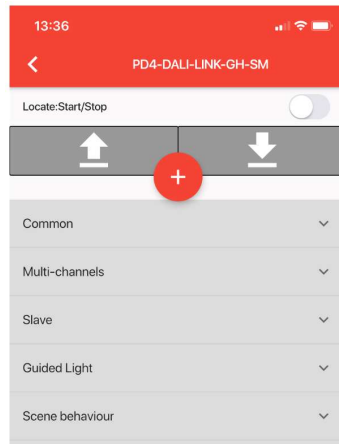

Common
Multi-channels
Slave
Guided Light
Scene behaviour

Common

Target group
Motion Sensitivity
Master Operation Mode
Follow-up Time
Output Type
Reflection Factor
Set Value Brightness
Regulating Speed
Switch-on-Level
Orientation Light
Orientation Light Level
Orientation Light Time
Power-on-Behavior
Level Transmit When Locking
Level Transmit When Unlocking
Burn-in-Time
Regulate Lag Time
Led indication
Switch off hysteresis
Delay on time
Delay off time

Multi-channels

Enable CH2
Offset CH2
Enable CH3
Offset CH3
Enable Board light
Board light mode
Joint control group for CH1+2+3

Slave

Repeat time motion

Guided Light

Motion in G0...G15, BC

Scene behaviour

Scene 0...15

Group 0...15, broadcast

High, Medium, Low

Fully-Automatic, Semi-Automatic, CDS, Master off

1s... 2h59min

Regulating, Switching

Very bright (1), Bright (0,5), Medium (0,33), Dark (0,25), Very dark (0,2)

5...2500lux

Fast, Medium, Slow

Calculated, 5%, 10%, 20%, 30%, 40%, 50%, 60%, 70%, 80%, 90%, 100%

Off, Permanent, Timed

5...100%

1s... 2h59min

No action, On, Off

Off, 5%, 10%, 20%, 30%, 40%, 50%, 60%, 70%, 80%, 90%, 100%, Deactivated

Off, 5%, 10%, 20%, 30%, 40%, 50%, 60%, 70%, 80%, 90%, 100%, Deactivated

1...100hour

0...20s

On, Off

5...1000Lux

1s... 2h59min

1s... 2h59min

Deactive, Active

0%, -5%, -10%, -15%, -20%, -25%, -30%

Deactive, Active

0%, -5%, -10%, -15%, -20%, -25%, -30%

Deactive, Active

Fully-Automatic, Semi-Automatic

Deactive, Active

1s... 2h59min

Main Light, Orien. Light, Ignore

B.E.G LOCK, B.E.G UNLOCK, Auto-off, Ignore

Relä 92849

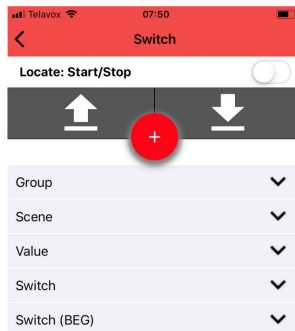

Group
Scene
Value
Switch
Switch (BEG)

Group
Group 0...15

Scene
Scene 0...15

Value
Max Level 1...100%
Min Level 1...100%
SysFail 0...100%, Ignore
PowerOn Level 0...100%, Ignore
Fade Time Disable, 0,7S, 1S, 1,4S, 2S, 2,8S
Fade Rate 357,8Step/S, 253Step/S, 178,9Step/S, 126,5Step/S, 89,4Step/S, 63,2Step/S, 44,7Step/S, 31,6Step/S, 22,4Step/S, 15,8Step/S, 11,2Step/S, 7,9Step/S, 5,6Step/S, 4Step/S, 2,8Step/S

Switch
Positive transition ON 0...100, Ignore
Positive transition OFF 0...100, Ignore
Negative transition ON 0...100, Ignore
Negative transition OFF 0...100, Ignore
Load error hold off time 0...100, Indefinite

Switch (BEG)
Operation mode Lamp, Cut-Off, HVAC, Impulse, Alarm, Blind
Repeater funktion Deactive, Active

Armatyr DALI/ LED driver

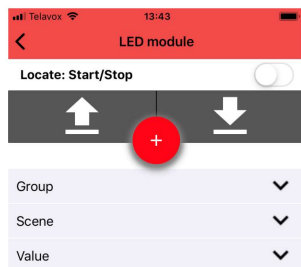

Group
Scene
Value

Group
Group 0...15

Scene
Scene 0...15

Value
 Max Level 1...100%
 Min Level 1...100%
 SysFail 0...100%, Ignore
 PowerOn Level 0...100%, Ignore
 Fade Time Disable, 0,7S, 1S, 1,4S, 2S, 2,8S
 Fade Rate 357,8Step/S, 253Step/S, 178,9Step/S, 126,5Step/S, 89,4Step/S, 63,2Step/S, 44,7Step/S, 31,6Step/S, 22,4Step/S, 15,8Step/S, 11,2Step/S, 7,9Step/S, 5,6Step/S, 4Step/S, 2,8Step/S